

Arts and Social Sciences Library Ground Floor

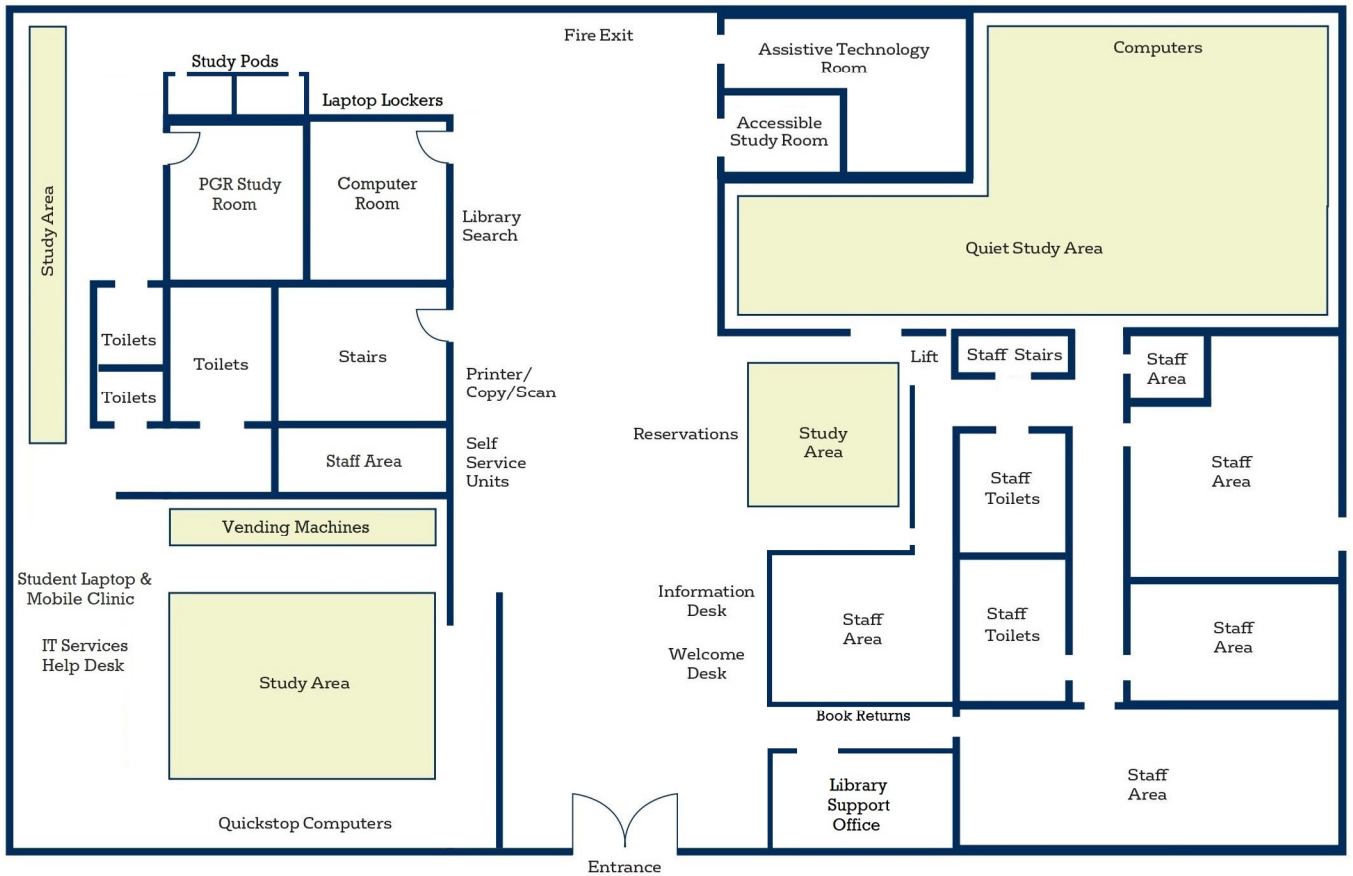

For more information about all libraries
and library-managed study spaces see:

- 🏠 bristol.ac.uk/library
- ✉ library-enquiries@bristol.ac.uk
- 📍 bristol.ac.uk/library/locations-opening
- ✚ bristol.ac.uk/library/accessibility-support
- 🐦 BristolUniLib
- 📷 [bristol_uni_lib](https://www.instagram.com/bristol_uni_lib)
- 📘 [/BristolUniLib](https://www.facebook.com/BristolUniLib)

Arts and Social Sciences Library First Floor

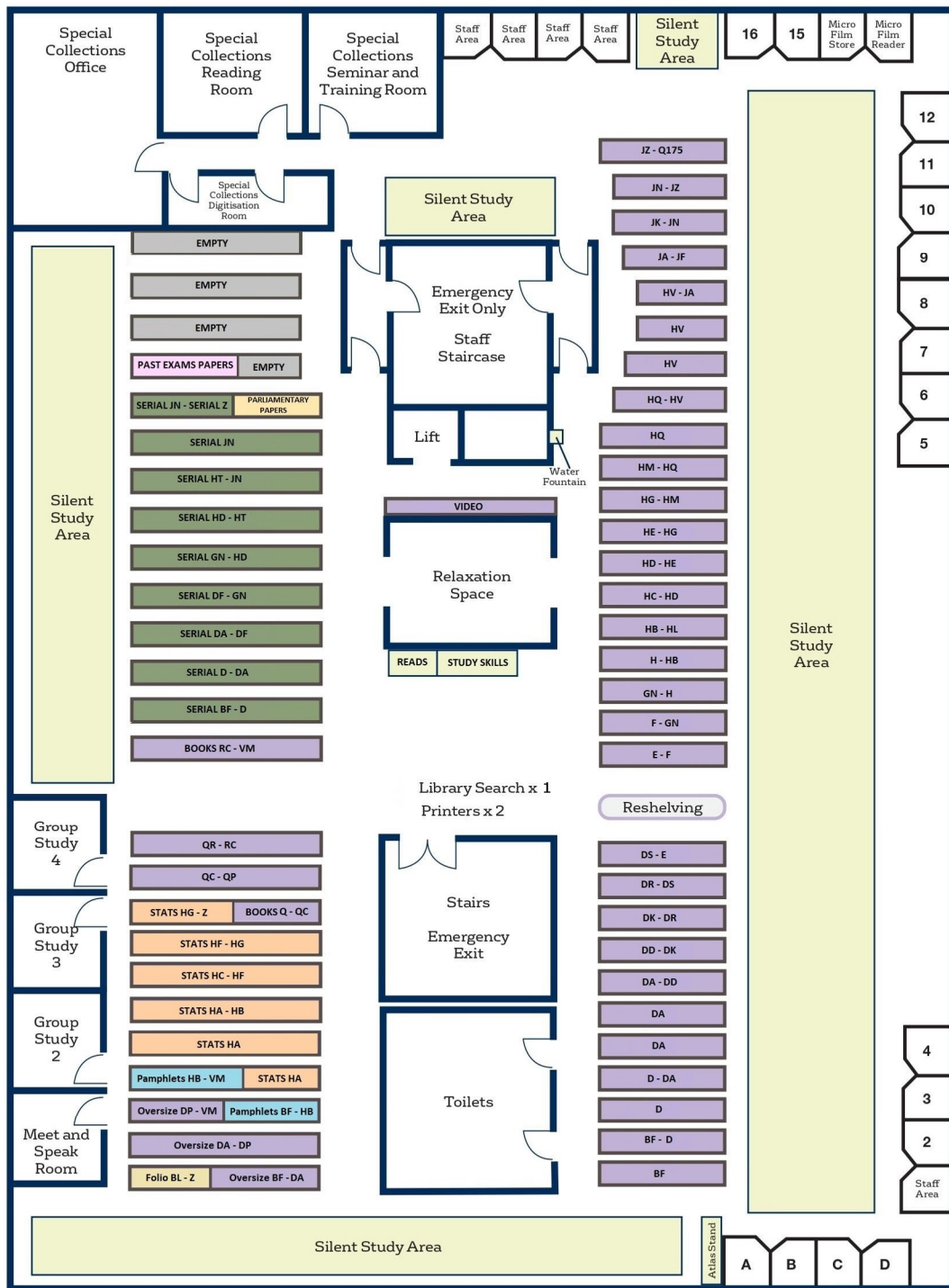

For more information about all libraries and library-managed study spaces see:

- 🏠 bristol.ac.uk/library
- ✉ library-enquiries@bristol.ac.uk
- 📍 bristol.ac.uk/library/locations-opening
- ⊕ bristol.ac.uk/library/accessibility-support
- 🐦 BristolUniLib
- 📷 [bristol_uni_lib](https://www.instagram.com/bristol_uni_lib)
- 📘 [/BristolUniLib](https://www.facebook.com/BristolUniLib)

Arts and Social Sciences Library Second Floor

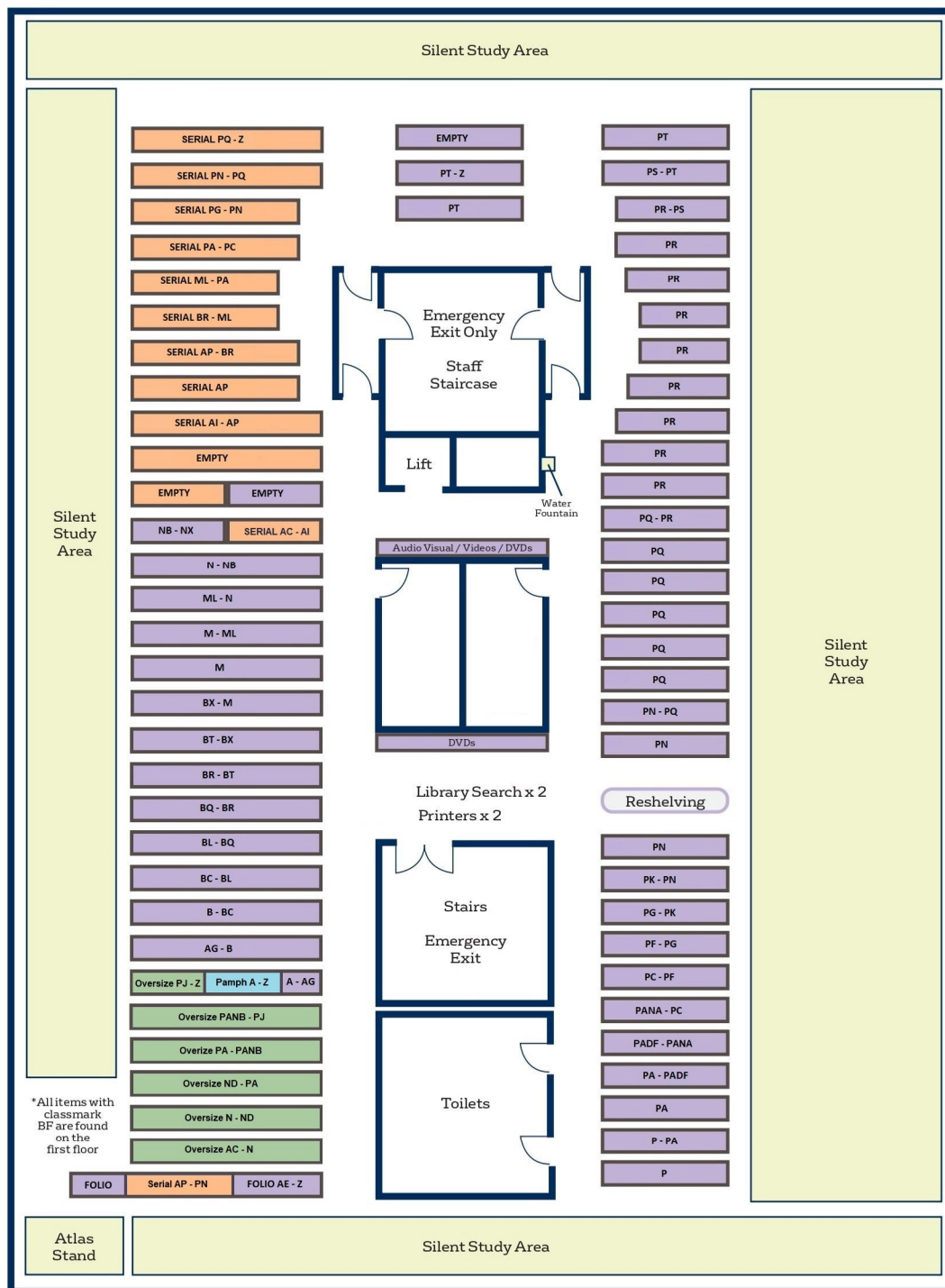

For more information about all libraries and library-managed study spaces see:

- 🏠 bristol.ac.uk/library
- ✉ library-enquiries@bristol.ac.uk
- 📍 bristol.ac.uk/library/locations-opening
- ✚ bristol.ac.uk/library/accessibility-support
- 🐦 BristolUniLib
- 📷 [bristol_uni_lib](https://www.instagram.com/bristol_uni_lib)
- 📘 [/BristolUniLib](https://www.facebook.com/BristolUniLib)

A summary of the class-marks used to organise books, journals and other printed material appears below.

For more specific locations within these broad class-marks consult Library Search.

Classmark	Subject	Floor
A	General works	2
B-BD, BH-BX	Philosophy, Religion and Theology	2
BF	Psychology	1
C-CT	Archaeology, Genealogy, Numismatics, Biography	1
D-DX	General history, European, Middle Eastern, Asian, African, Australasian history	1
E-F	History of the Americas	1
G-GV	Geography, Anthropology	1
H-HX	Social sciences, Finance, Management	1
J-JZ	Political science, International Relations	1
K-KW	Law	1
L-LT	Education	1
M-MT	Music	2
N-NX	Fine arts (including Architecture)	2
P-PT	Linguistics, Languages, Literatures (inc PABF-PANX – ancient Greek/Roman history)	2
Q-QR	Science	1
R-RZ	Medicine	1
S-SK	Agriculture	1
T-TX	Engineering, Photography	1
U-UH	Military science	1
V-VM	Naval science	1
Z-ZA	Bibliography, Information science	2
Restricted	Special Collections	Basement